

### Key Features

- Ultra-compact
- Based on TFF technology
- Ultra-low Insertion loss
- Stable at wide range of operating temperatures
- One side fiber feedthrough

### Applications

- CWDM networks, CATV networks.
- High speed multi-wavelength CWDM transceivers, line-card, portable testing equipment.



# Ultra Compact WDM

## Ultra Compact CWDM



### Parameter Specifications

Parameters	4 Channels	8 Channels	10 Channels	18 Channels	Units
Insertion Loss	≤1.2	≤1.5	≤1.5	≤2.0	dB
Ripple	≤0.5	≤0.5	≤0.5	≤0.5	dB
Polarization Dependent Loss	≤0.3	≤0.3	≤0.3	≤0.3	dB
Dimension	21 x 12 x 6.5	21 x 15.5 x 6.5	21 x 15.5 x 6.5	28 x 22.8 x 6.5	mm
Channel Center Wavelengths	1271 - 1611				nm
Channel Spacing	20				nm
Channel Passband	$\lambda_c \pm 6.5$ (Min.)				nm
Isolation-Adjacent	≥30				dB
Isolation-Non-adjacent	≥40				dB
Return Loss	≥45				dB
Directivity	≥50				dB

Notes:

1. The above specs exclude connector loss, each pair of connectors.add 0.2dB.

### Operating Conditions

Parameters	4 Channels	8 Channels	10 Channels	18 Channels	Units
Maximum Power handling	500				mW
Operating Temperature*	-5 ~ +70				°C
Storage Temperature	-40 ~ +85				°C
Operation Humidity	5 to 95 % Relative Humidity				

\* Contact us for your Industrial temperature application.

**Mechanical Dimensions**

4 Channels

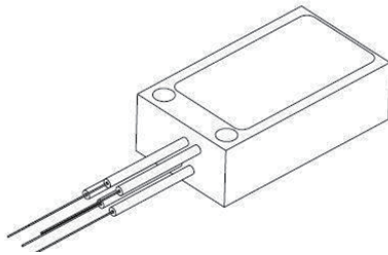
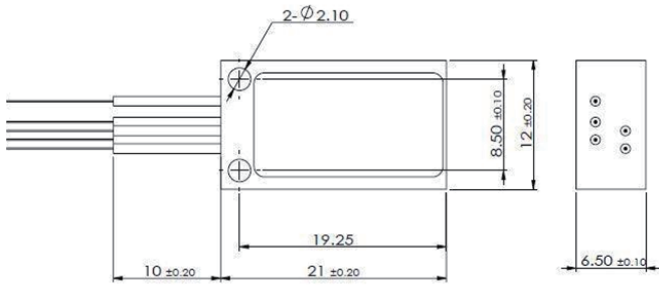

8 Channels

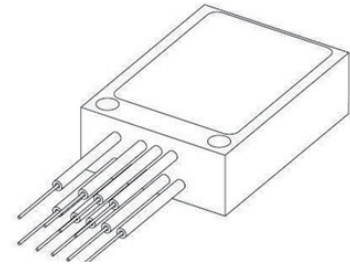
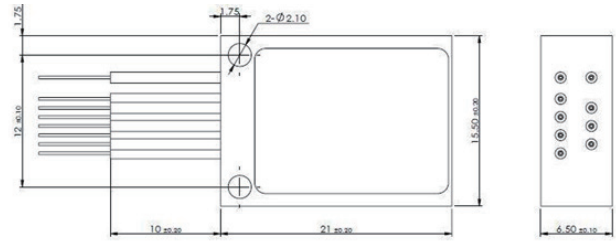

10 Channels

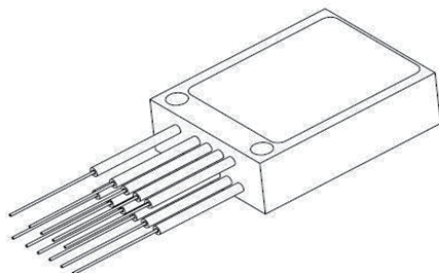
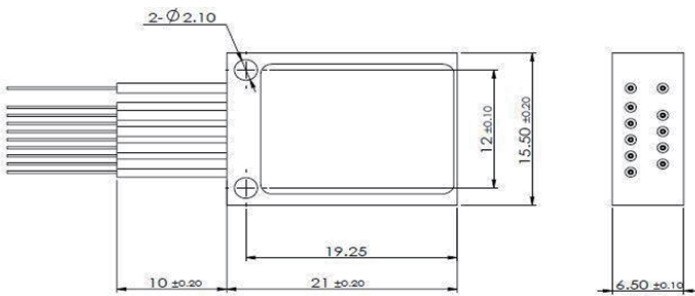

18 Channels

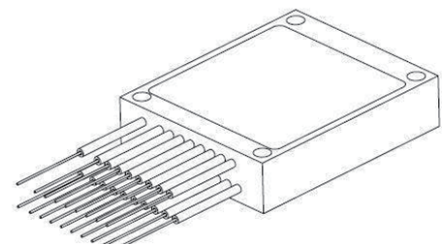
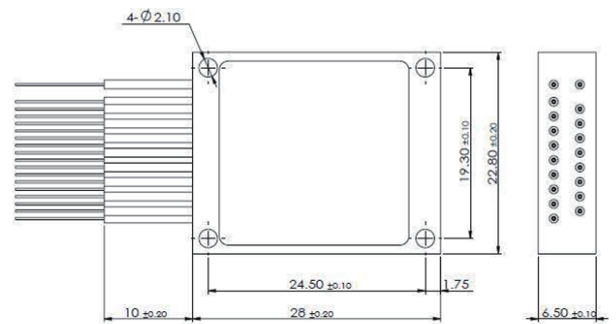

**Part Number Scheme: Ultra Compact CWDM Modules**

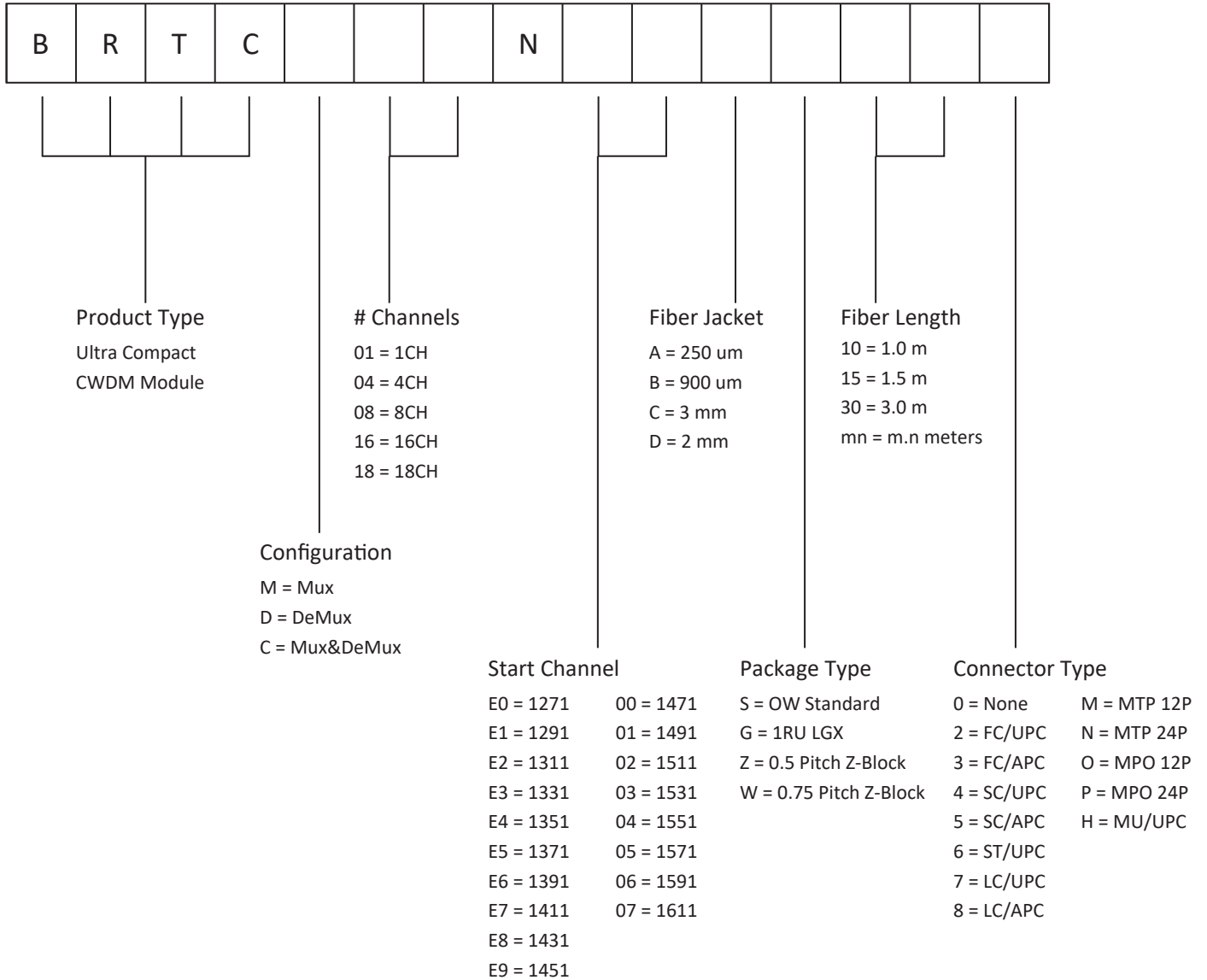

Notes: Fiber type used for this product: XB G657 .A1

Notice: Our spec temperature (N) is commercial temp. range -5 ~ 70 °C. Please contact us if you need industrial temperature (T) range -40 ~ 80 °C. Or extender range of (E) -20~80 °C

**OptiWorks Headquarters**

**OptiWorks, Inc.**

47211 Bayside Parkway, Fremont, CA 94538, USA  
Phone +1 510 438 4560 sales@optiworks.com  
www.optiworks.com

**Global Sales Contacts**

<b>OptiWorks (Kunshan) Co., Ltd.</b>	Phone +86 512 5763 0880	sales_china@optiworks.com
<b>OptiWorks (Shanghai) Co., Ltd.</b>	Phone +86 021 6485 8787	sales_china@optiworks.com
<b>BizLink International Corp.</b>	Phone +886 2 8226 1000	sales_tw@bizlinktech.com